



GB Mounting instructions

CZ Montážní návod

H Szerelési utasítás

RU Инструкция по монтажу

D/A Montageanleitung

PL Instrukcja montażu

RO Instrucțiuni de montaj

ES Manual de instrucciones

FR Notice de montage

NL Montage instructie

LT Montavimo instrukcija

SK Montážny návod

PO60-60

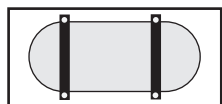

PO80-80

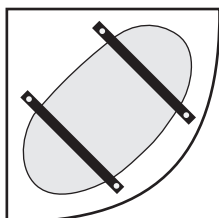

PO100-100

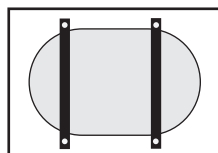

PO60-80

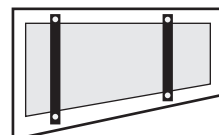

PO60-100

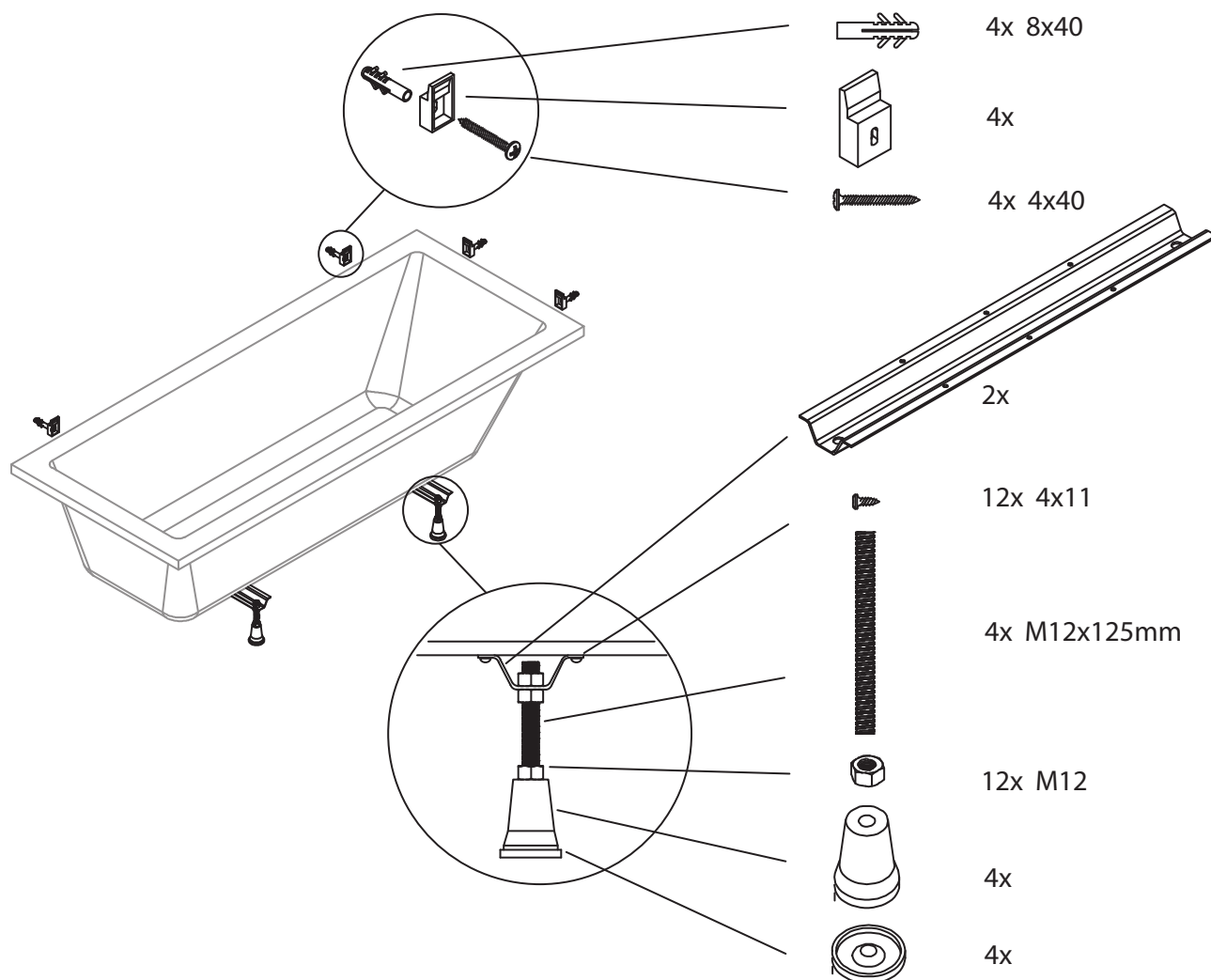
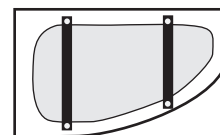

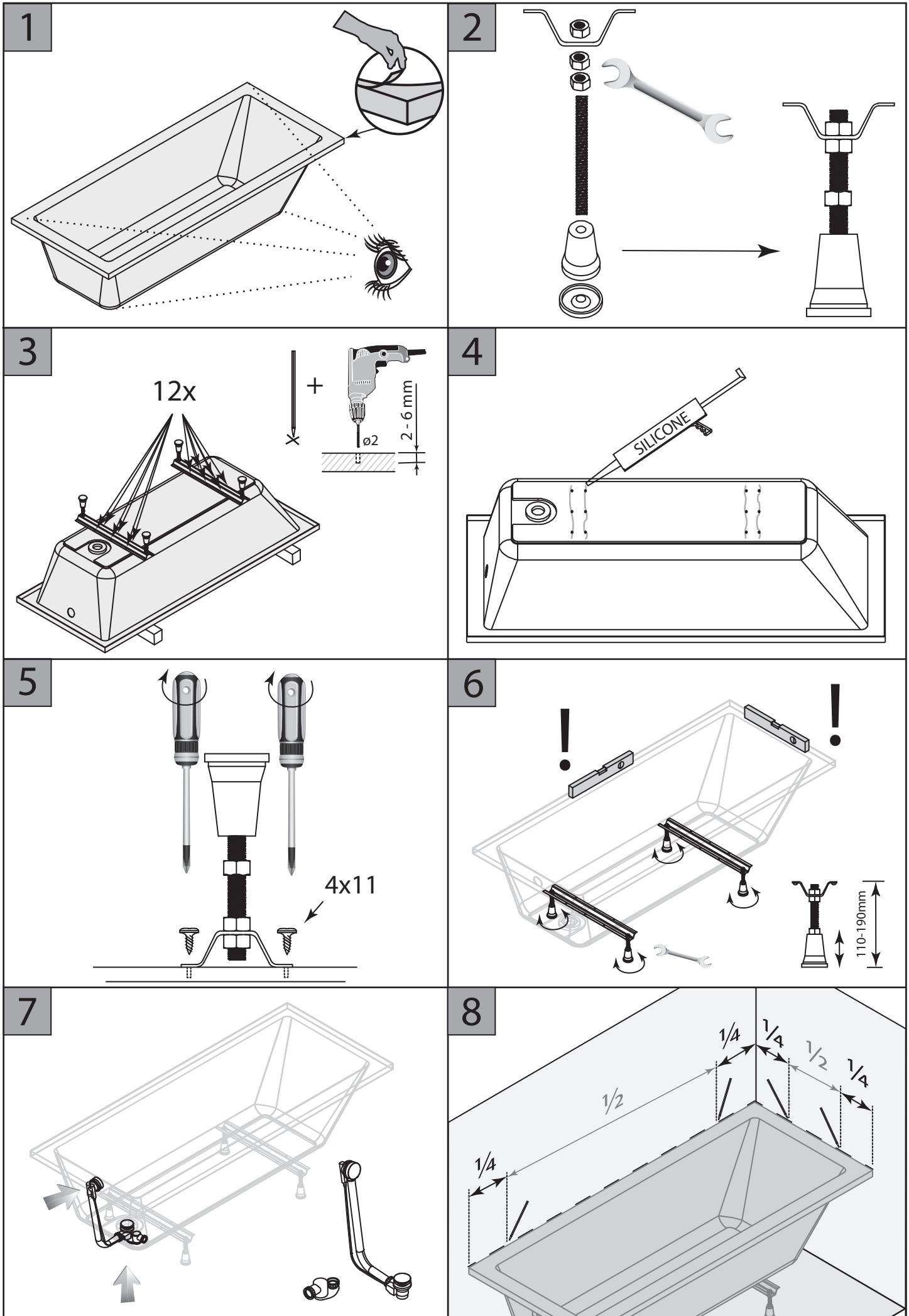

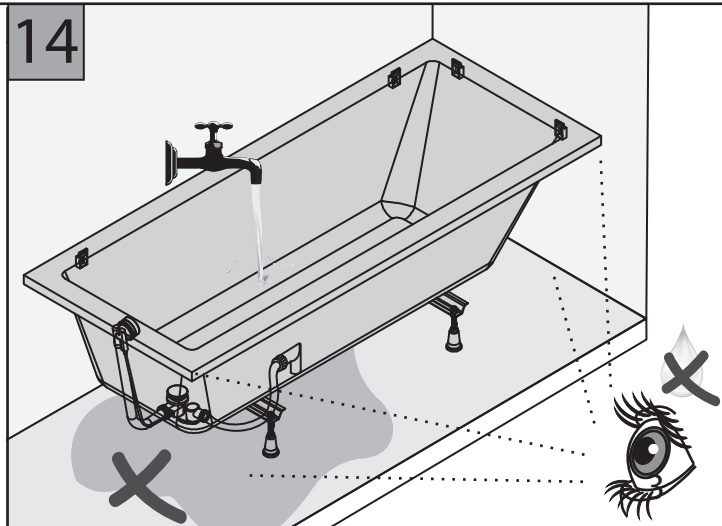
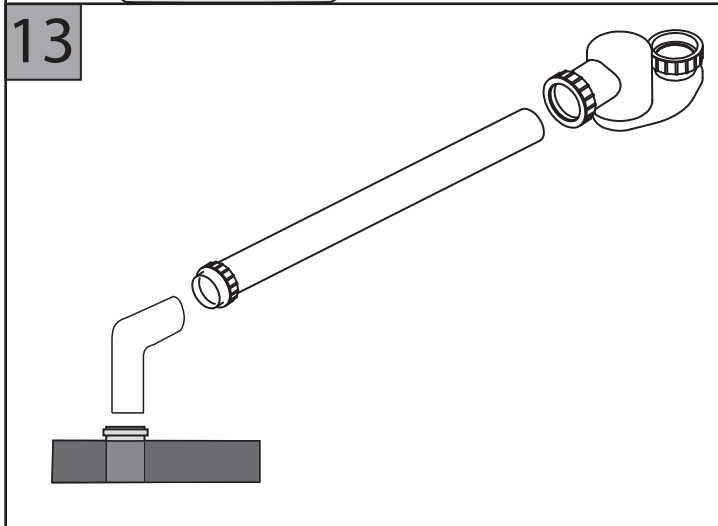
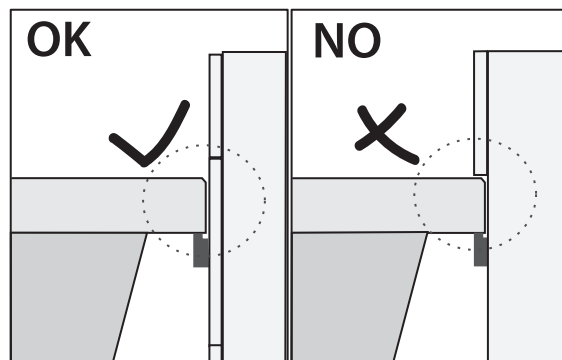
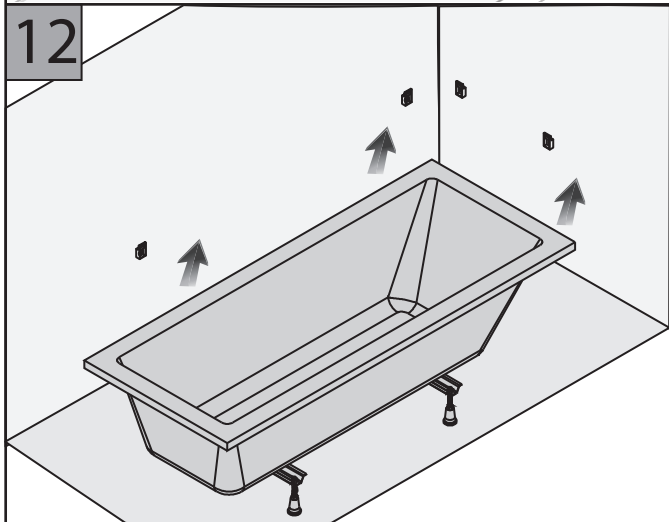
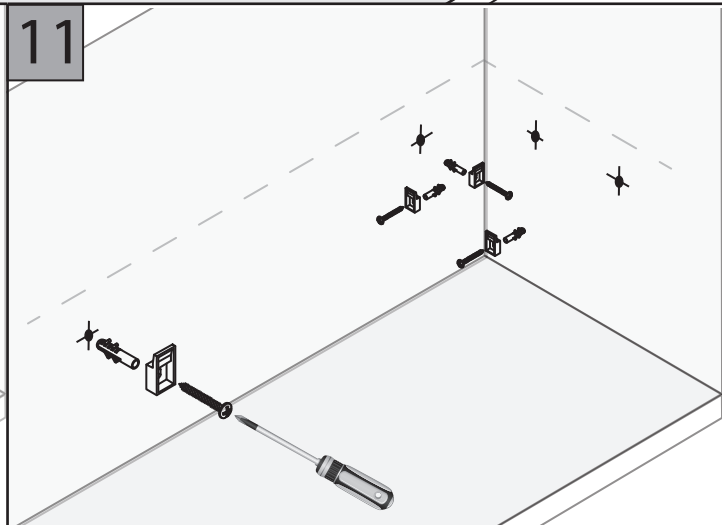
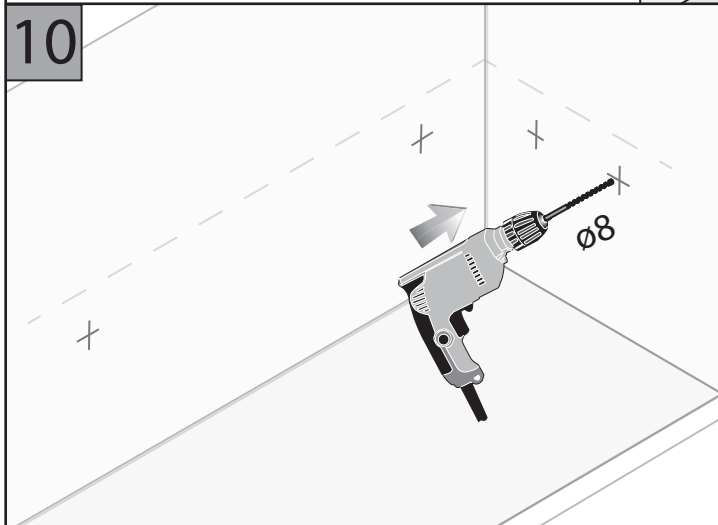
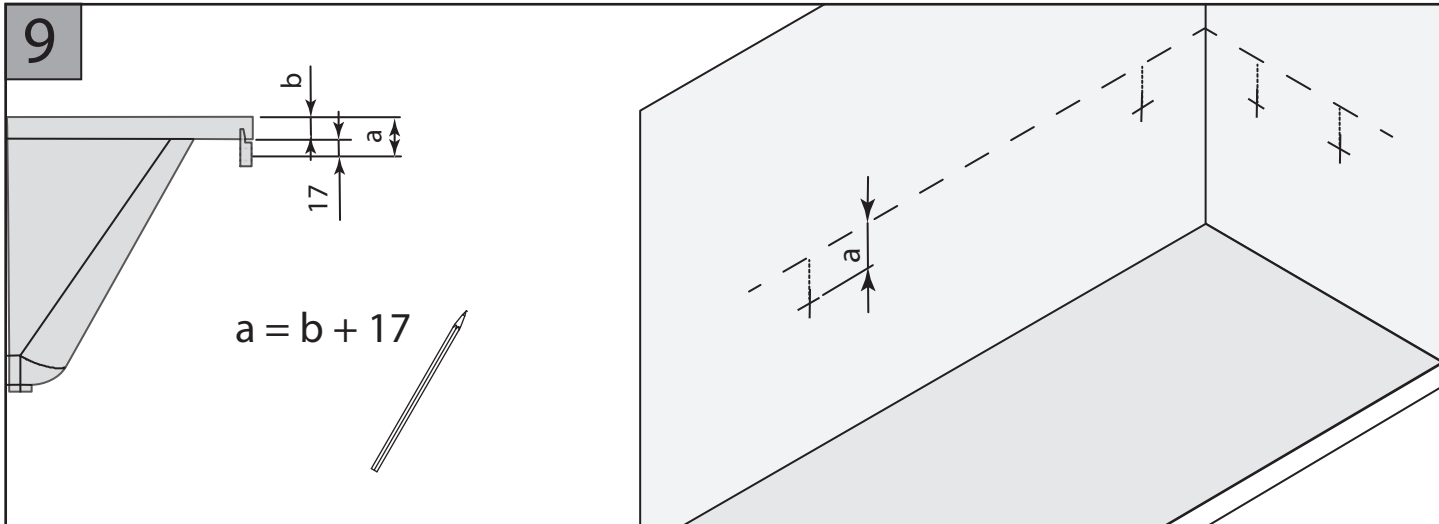

15

a)

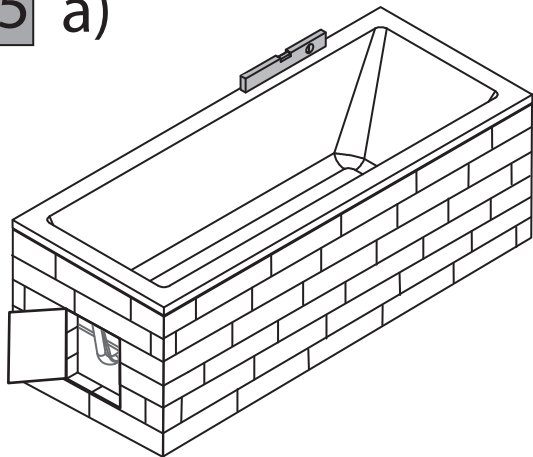

b)

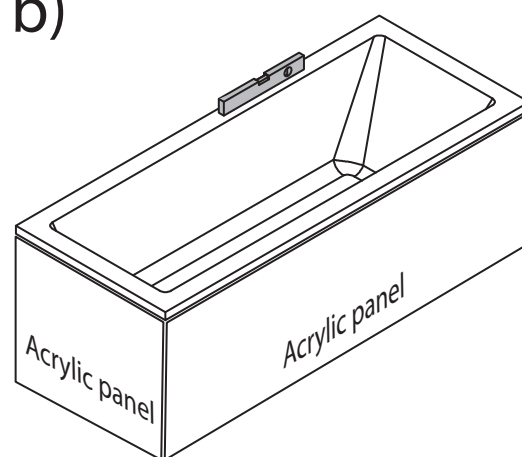

16

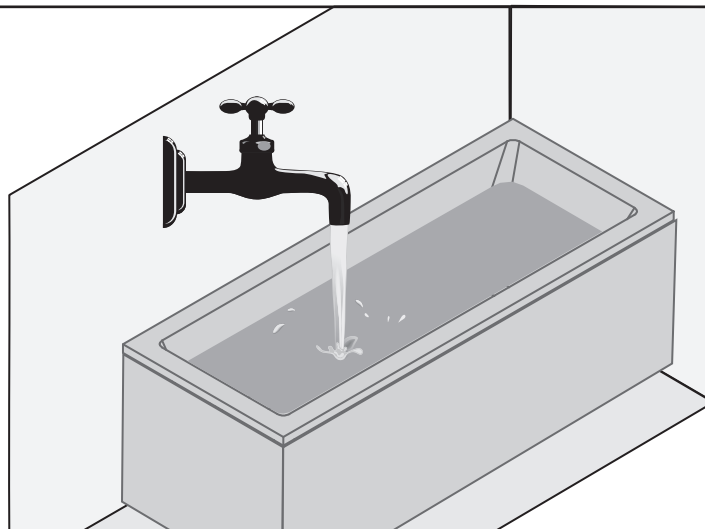

17

a)

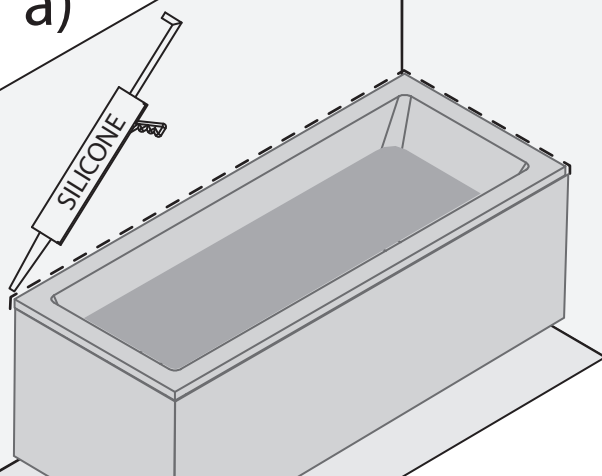

b)

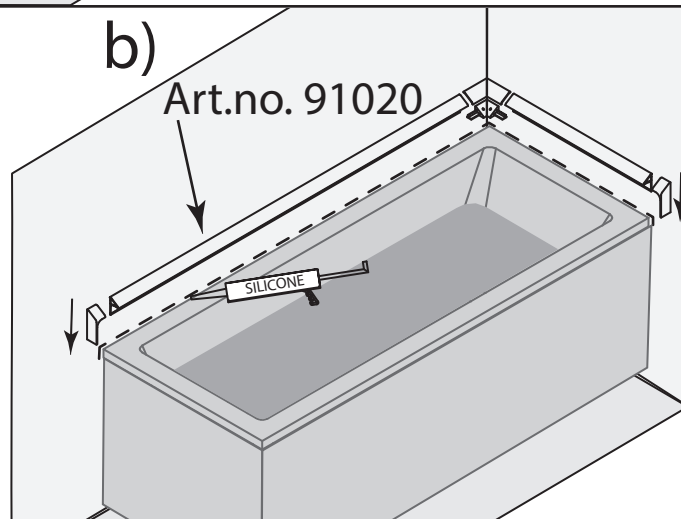

18

24 h

