

# INSTALLATION INSTRUCTION

## TWO HANDLES SHOWER MIXER

### ※ACCESSORIES CHECKING

#### LIST OF THE STANDARD ACCESSORIES:

Please double-check the accessory list hereafter and contact our company or our distributor for any unconformity.

Remarks:

- 1.Without affecting their performing,accessories may be changed without further notice;
- 2.Drawings for reference only, Product size & shape refer to actual faucet.

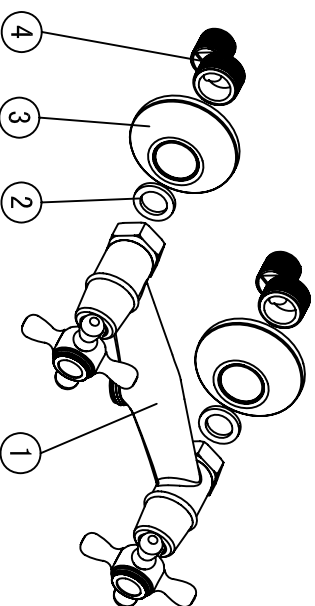

Code	The Accessory List	Quantity
1	Main body	1
2	O-ring	2
3	Flange	2
4	Eccentric nut	2

### ※Installation Instructions

- ☆ Do not disassemble the main body, as it has been installed & commissioned correctly & precisely before leaving the factory;
- ☆ To avoid the faucet from jamming,do flush the water pipe before installation;
- ☆ After installation,make sure every joint safely sealed & no leaking;
- ☆ Using condition:Working pressure at 0.05-1.0MPa(including cold & hot water pressure), with applicable water temperature:4℃-80℃;
- ☆ Make sure to connect the hot/cold inlet pipe correctly,if standing in front,hot water pipe connecting to the left & cold water pipe connecting to the right.

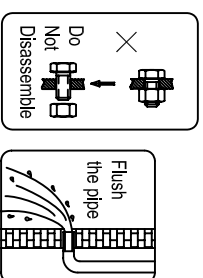

### ※Installation Procedures

☆ Please install the connction hose into the wall according to the installation Procedures.

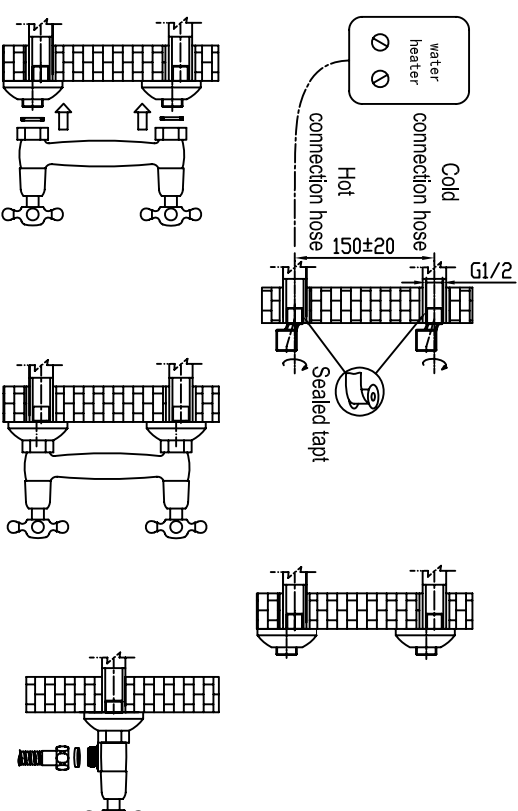

### ※Usage

☆How to operate the handwheel

- 1.The left handwheel: To turn on the hot water directly,The largest rang is 90° and turn off rightabout.
- 2.The right handwheel: To turn on the cold water rightabout and turn off directly.

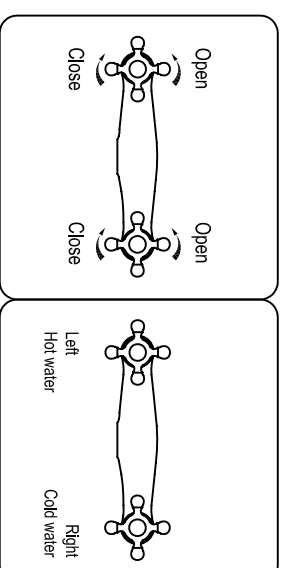

### ※Cleaning & Maintenance

☆ To keep the product clean & shining, follow the as below:

- 1.Flush with clean water & dry with soft cloth only;
- 2.If any dirt, clean with soft liquid or transparent glass detergent;
- 3.Do not use any scrubbing detergent, polisher, same-cloth, paper tissue or scraper;
- 4.Do not use acid detergent, indissolvable gran-like detergent or soap;

